

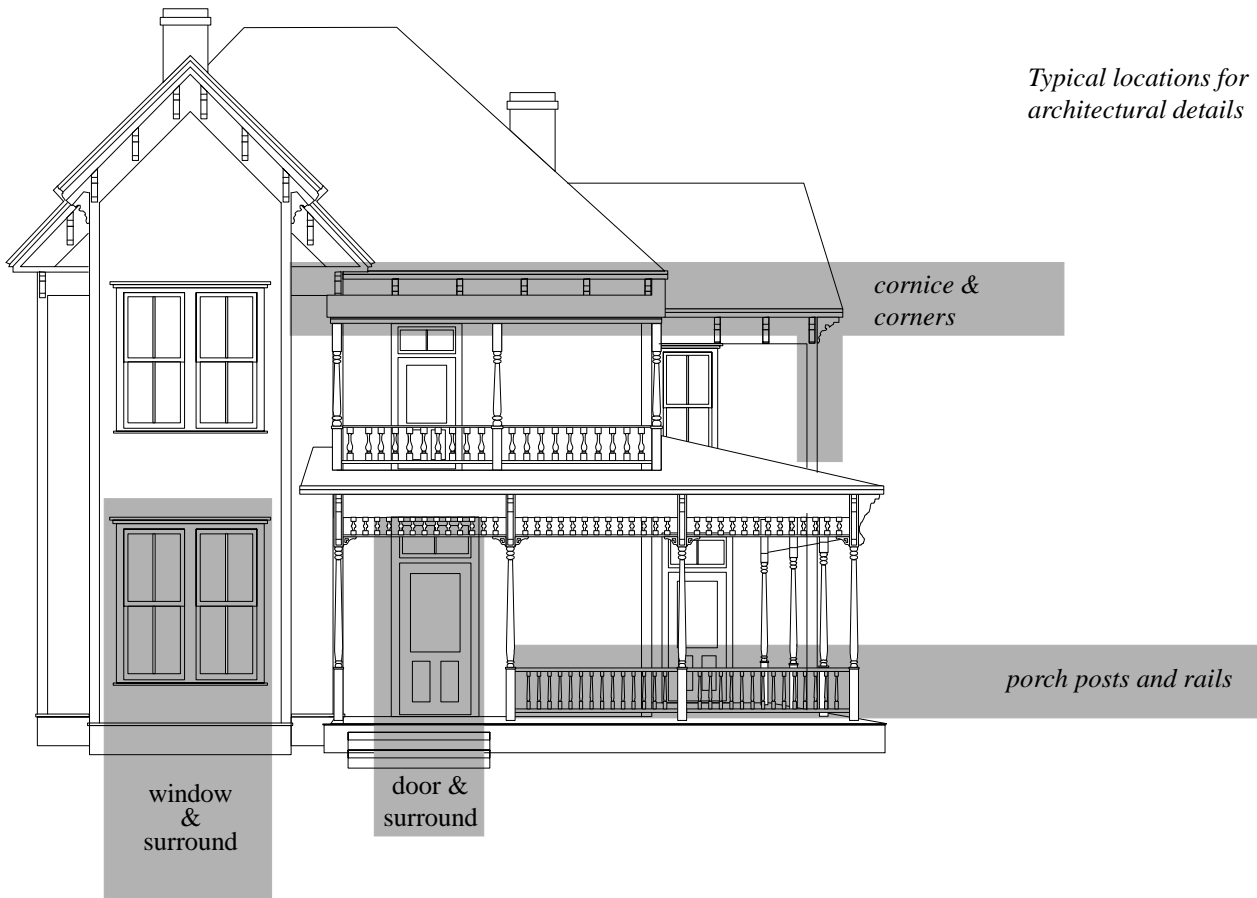

Materials and ornamentation represent an important and complicated facet in the design continuity of a historic district. While it is important that materials of a similar composition, texture and appearance be used with new construction, it is equally important that historic materials and ornamentation are not copied directly onto new buildings to create a false history. The object of new design in historic neighborhoods is to preserve the continuity of the streetscape, not to create new historic buildings.

- Reference existing historic buildings in the district with regard to materials and ornamentation.
- Choose wood for lapboard siding. Modern materials with the same texture (smooth, no fake wood grain) and appearance (traditional width or exposure), such as cement board and vinyl siding (discouraged) are acceptable.
- Do not use modern materials with an appearance atypical to the district such as synthetic stucco (E.I.F.S.).
- Do not use traditional building materials not found in the district.
- Use continuous brick or brick pier with recessed infill for foundations.
- Use brick on chimneys.
- Use an equal or lesser degree of ornamentation as found on historic houses in the district.

Typical locations for architectural details



If vinyl or cement board is used it should not have a faux wood grain texture

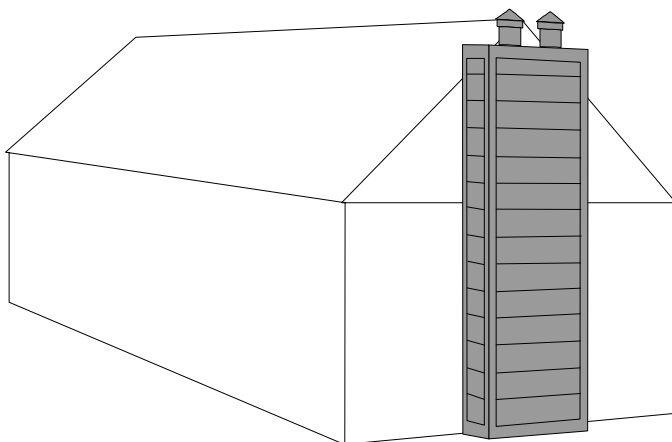

*Chimneys should be clad in brick and should have "shoulders". Boxed, lap board chimneys are inappropriate and must **not** be used.*